

Open spaces within the development are to have an Emorogate 59.22%

grass mix with avenues of trees 24-16 cm triple slaked. To the

Eastern end of the development, an Emorogate 50% grass & wild flowers mix predominates. Swales & pond embankments to have Emorogate 50%

Native Edge Mix to northern boundary 20% Hawthorn, 20% Hazel, 5% Elder, 20% Dogwood, 5% Wayfaring tree, 5% Spindle, 20% Field maple, 5% Holly, 5% Dog rose, 5% Alder buckthorn.

A species rich mix to give a biodiverse habitat with nesting sites, berries & nuts for food, food plants for butterflies - Holly (Holly blue) & buckthorn (Brinstone)

Trees within mix - Crab apple, birch, Rowan, Bird cherry & Whitebeam.

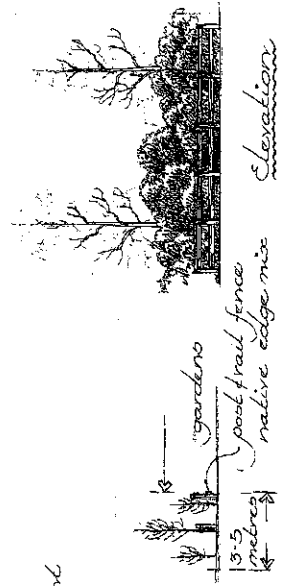

Open space with avenue trees, extending into open grassland with ponds & parkland trees & mow paths.

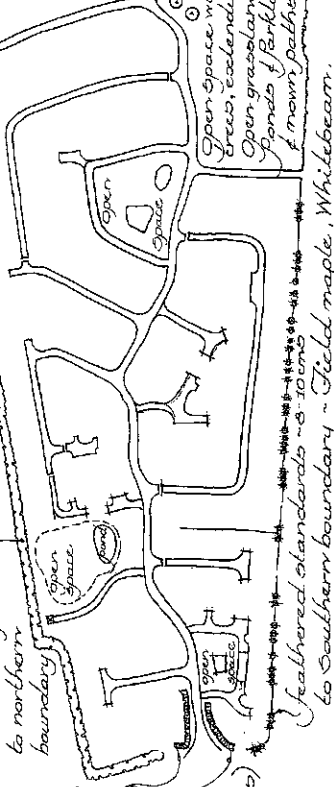

Plot 279

Plot 280

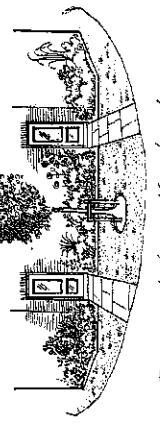

Corner plots with planting light to building including herbaceous & grasses & distinctive shrubs.

Larkfleet Homes

Jernwood, Newark

Planting Principles / Overview

1:100 & 1:20

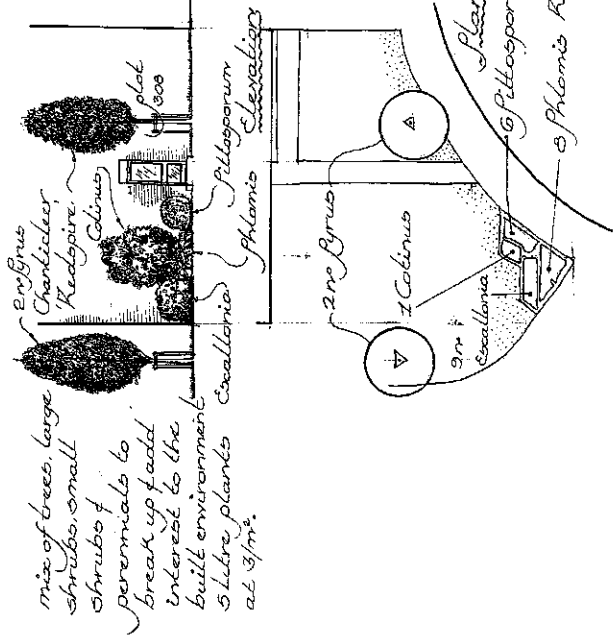
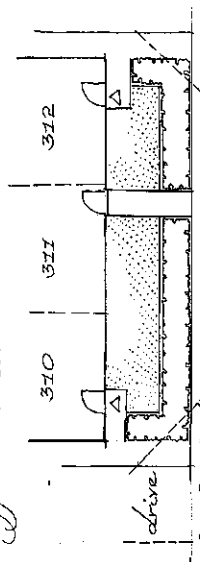

# Larkfleet Home - Fernwood, Newark - Landscape Proposals

August 2019 1:500 at A1 Sheet 14 of 14 LH/FN/LP1

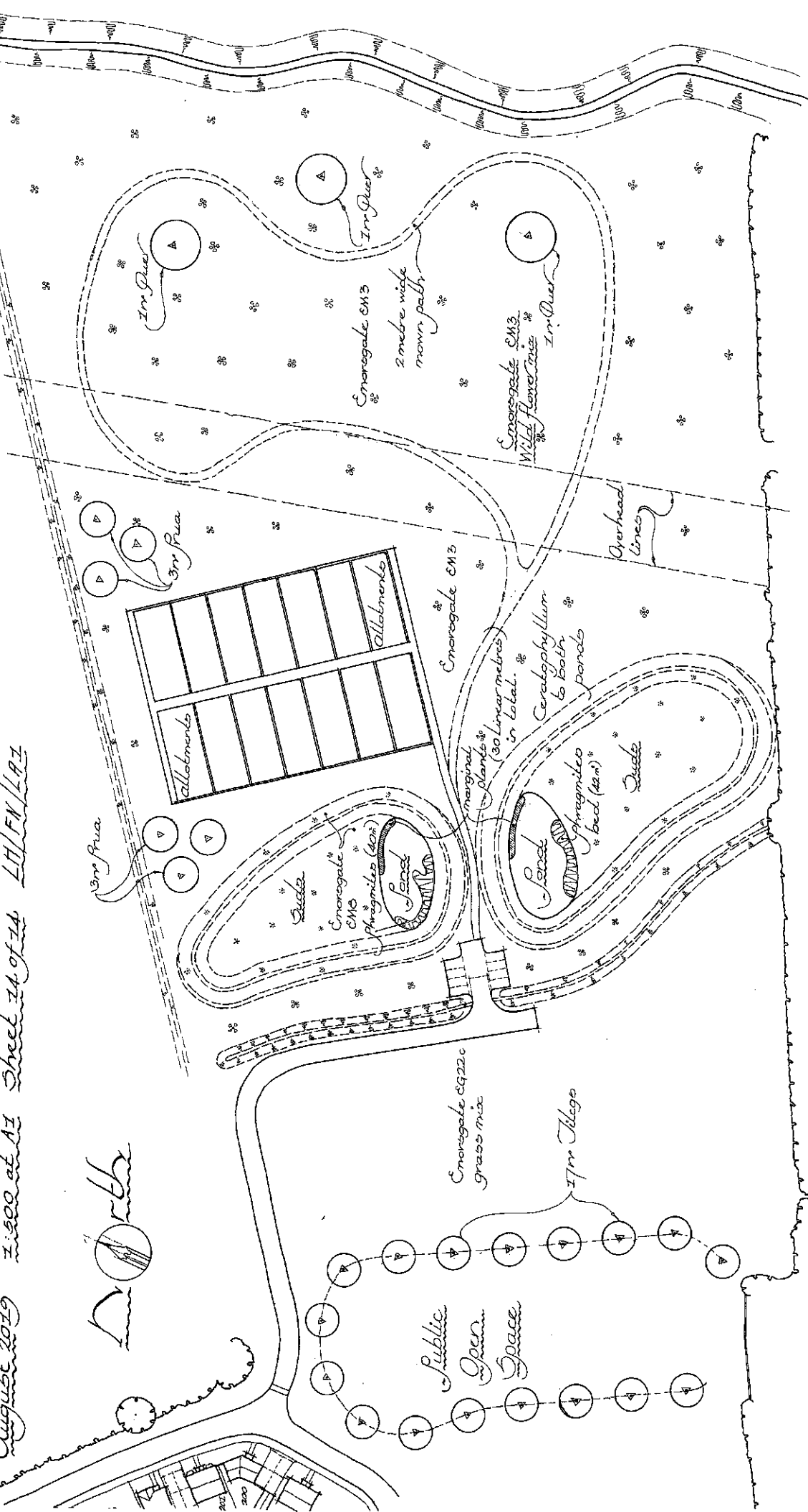
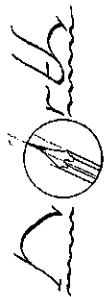

# Larkfleet Homes

## Fernwood, Newark - Landscape Proposals

£ 500 at A1 ~ sheet 13 of 14 August 2019 ~ LH-FN-LAZ

*D. Orth*

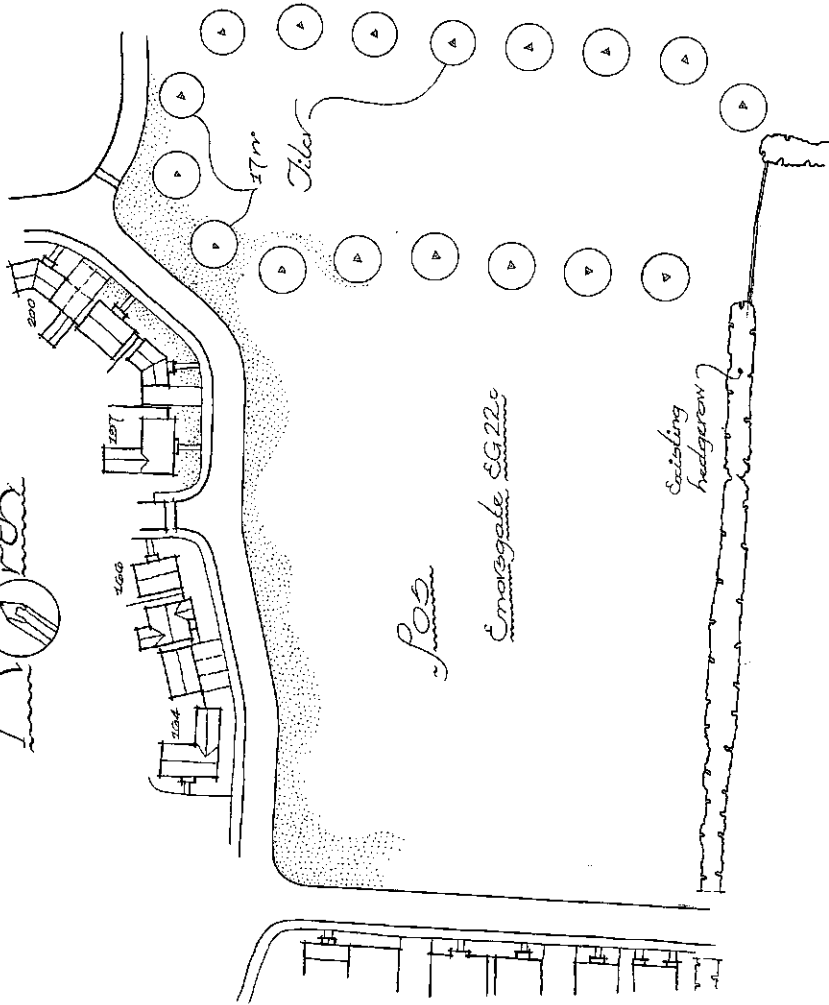

### Key

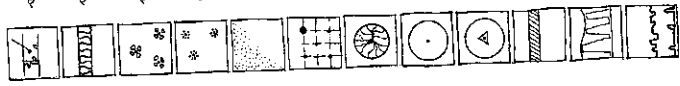

- ↳ denotes shrub planting
- ↳ denotes hedge planting
- ↳ denotes Emorgate CM3
- ↳ denotes Emorgate EM8
- ↳ denotes Emorgate SG22
- ↳ denotes native edge mix
- ↳ denotes specimen shrub
- ↳ denotes proposed tree planting
- ↳ denotes triple staked tree planting
- ↳ denotes marginal planting
- ↳ denotes phragmites planting
- ↳ denotes existing hedging



- ↳ denotes single behind linearized timber edge
- ↳ denotes feathered standard trees to Southern boundary

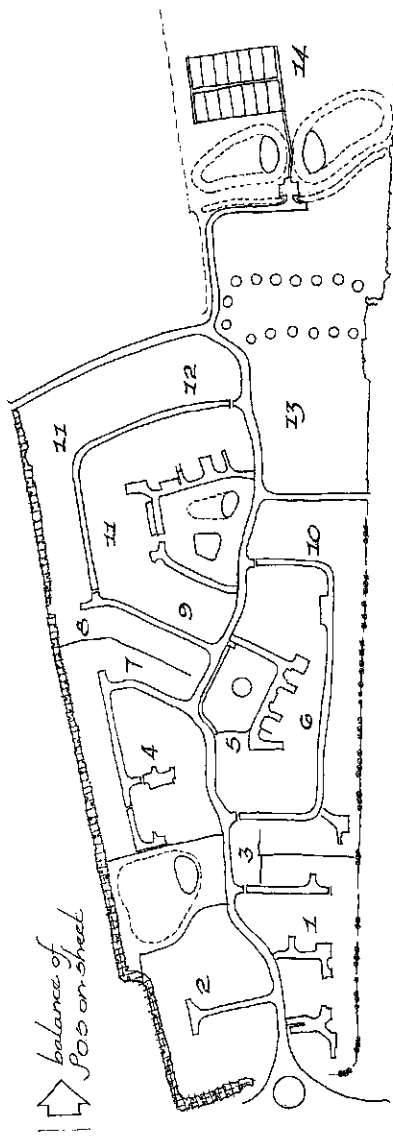

↑ balance of P03 on sheet

Key to locations of drawing sheets

# Leakly Fleet Homes ~ Fernwood, Newark ~ Landscape Proposals

August 2019 ~ 7:200 at 41 ~ Sheet 12 of 24 ~ LH/EM/LAI

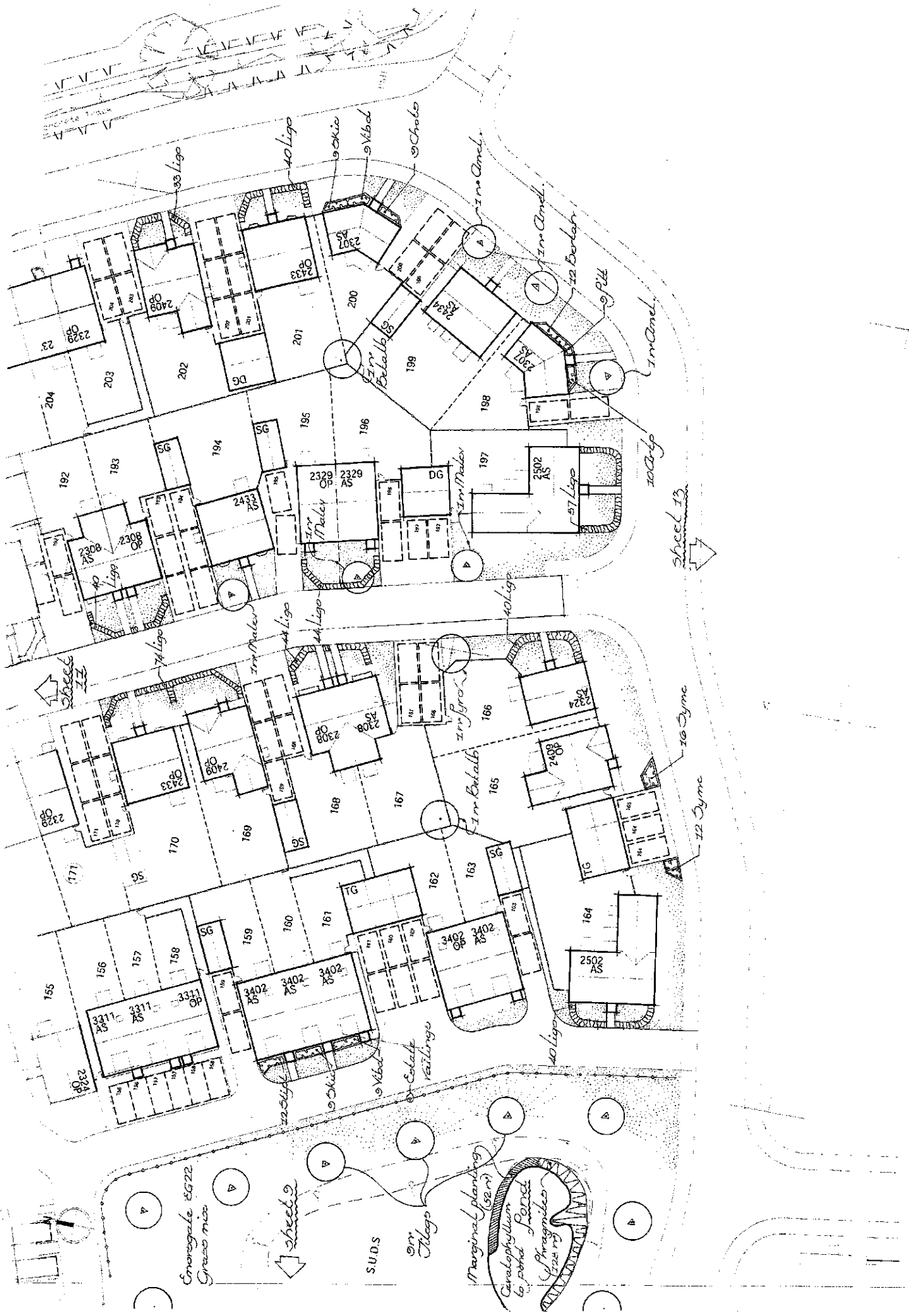

Larkfleet Homes ~ Fernwood, Newark - Landscape Proposals

July 2020 (Original drawing Aug 2019) - Sheet 31 of 34 - L4/EN/LR/rev.1





CANNONVILLE V/UMED ~ JERWOOD, LUMENARA ~ LANDSCAPE PROPOSALS.

August 2019 ~ #1200 at A1 ~ Sheet 9 of 24 ~ LH/FW/LTA

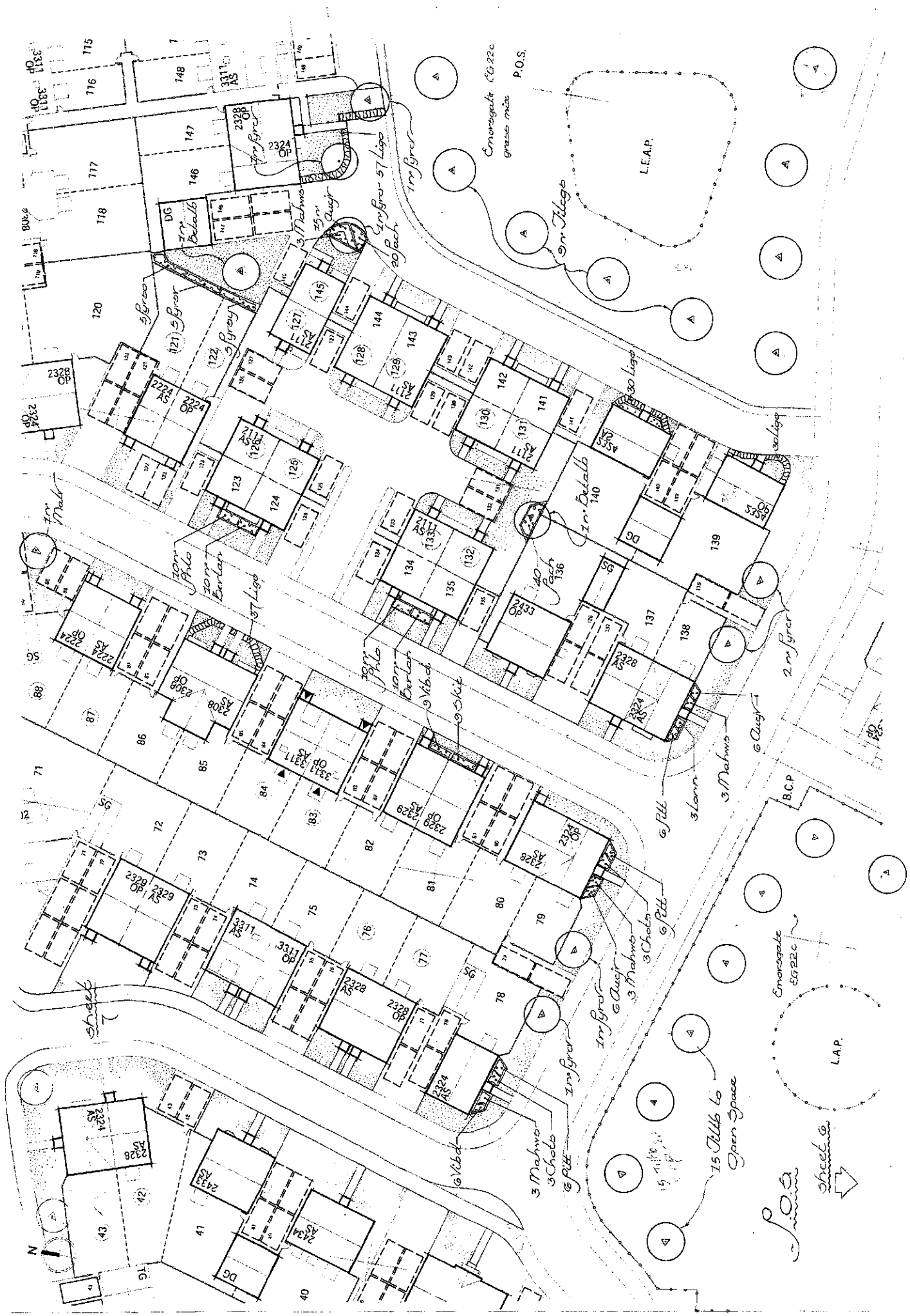







Larkfleet Homes - Fernwood, Newark - Landscape Proposals

August 2019, 1:200 at A - Sheet 6 of 14

LULLEN/LAZ

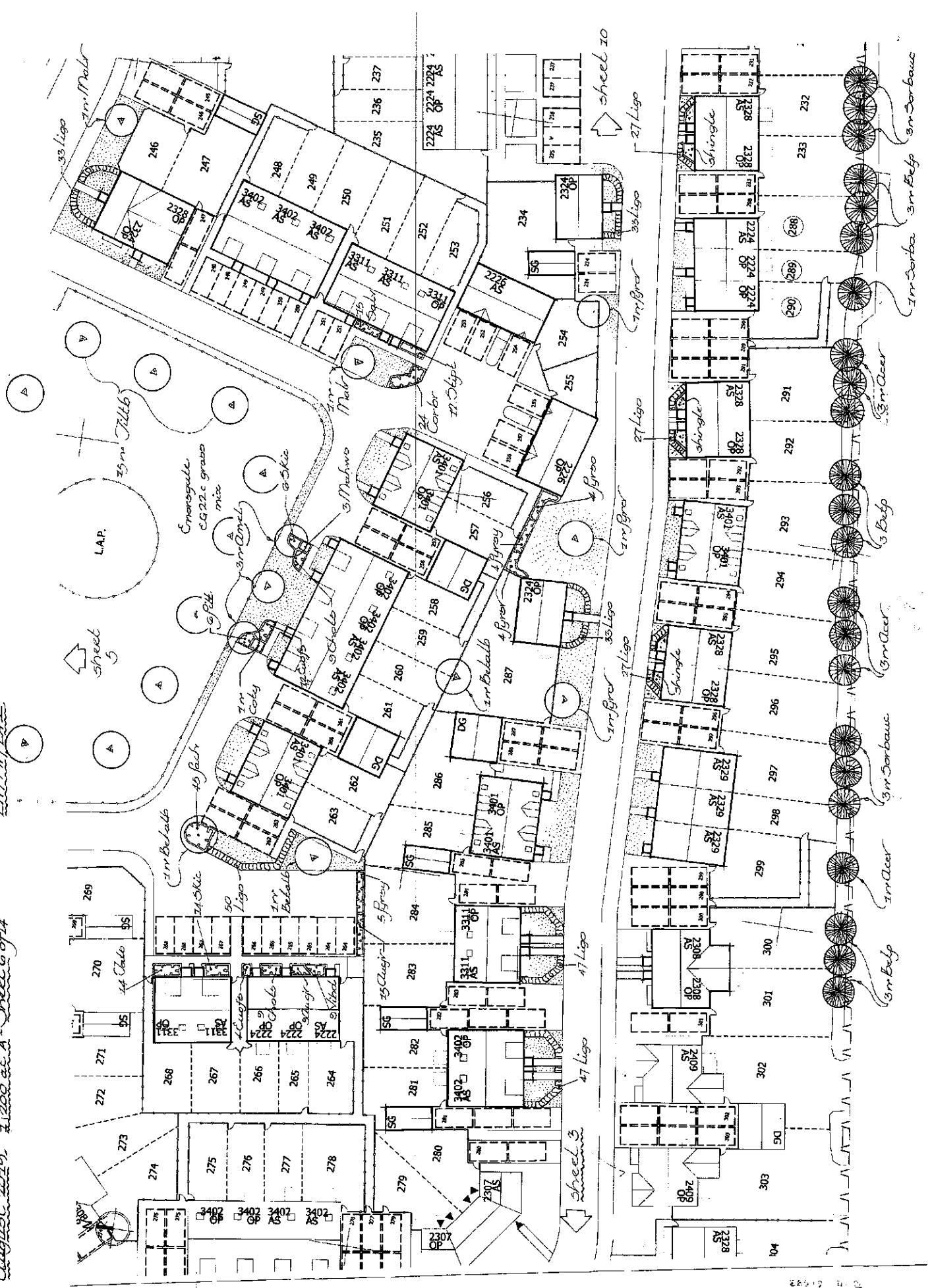

Larkfleet Homes ~ Fernwood, Newark ~ Landscape Proposals

1:200 at A1 ~ August 2019 ~ Sheet 5 of 14 LH-FW-LA-1

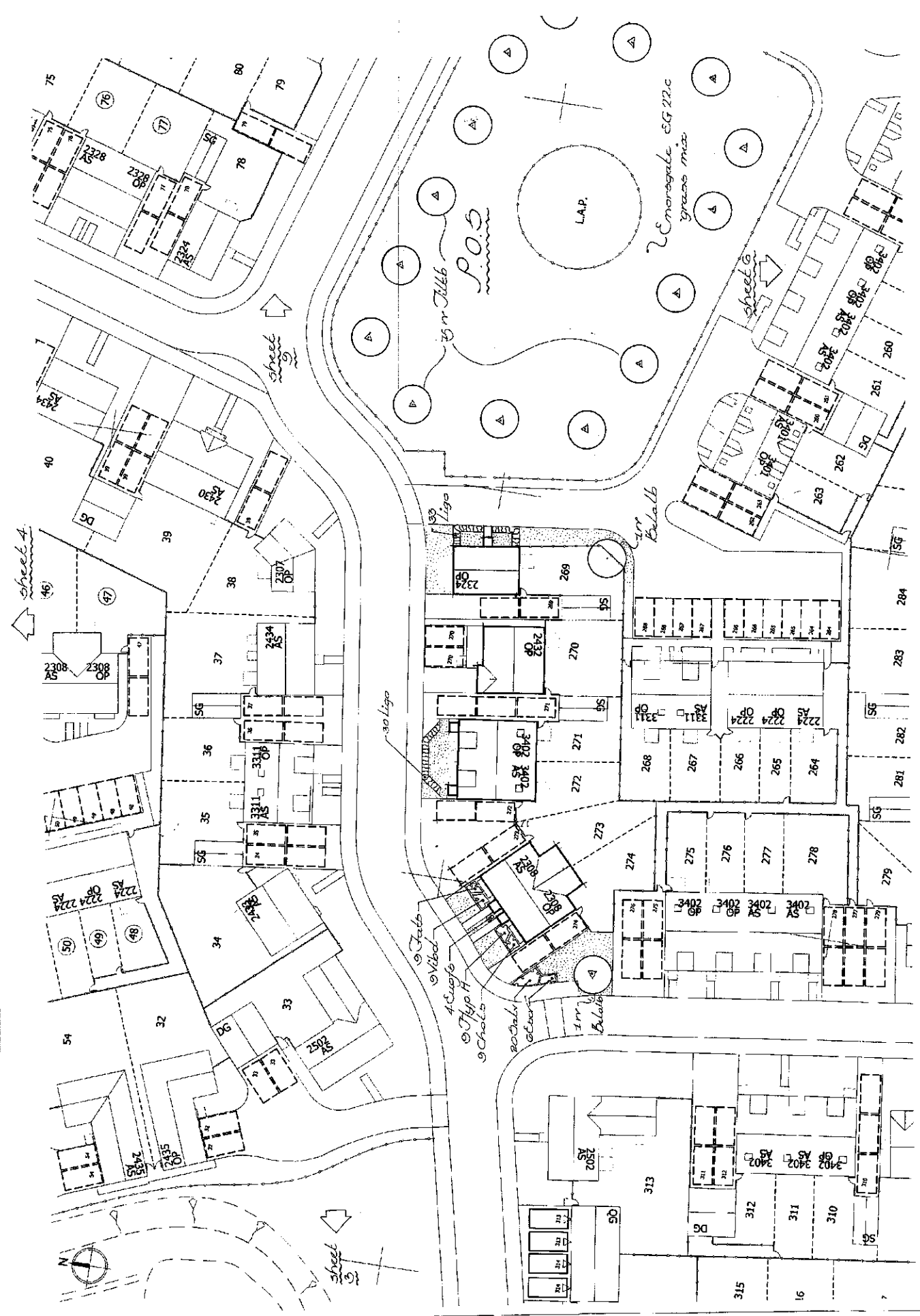

# Larkfleet Homes - Fernwood, Newark - Landscape Proposals

August 2019 ~ Sheet 4 of 74 ~ 7:200 d.d.AZ ~ 1st A - Planning changes July 20 2019

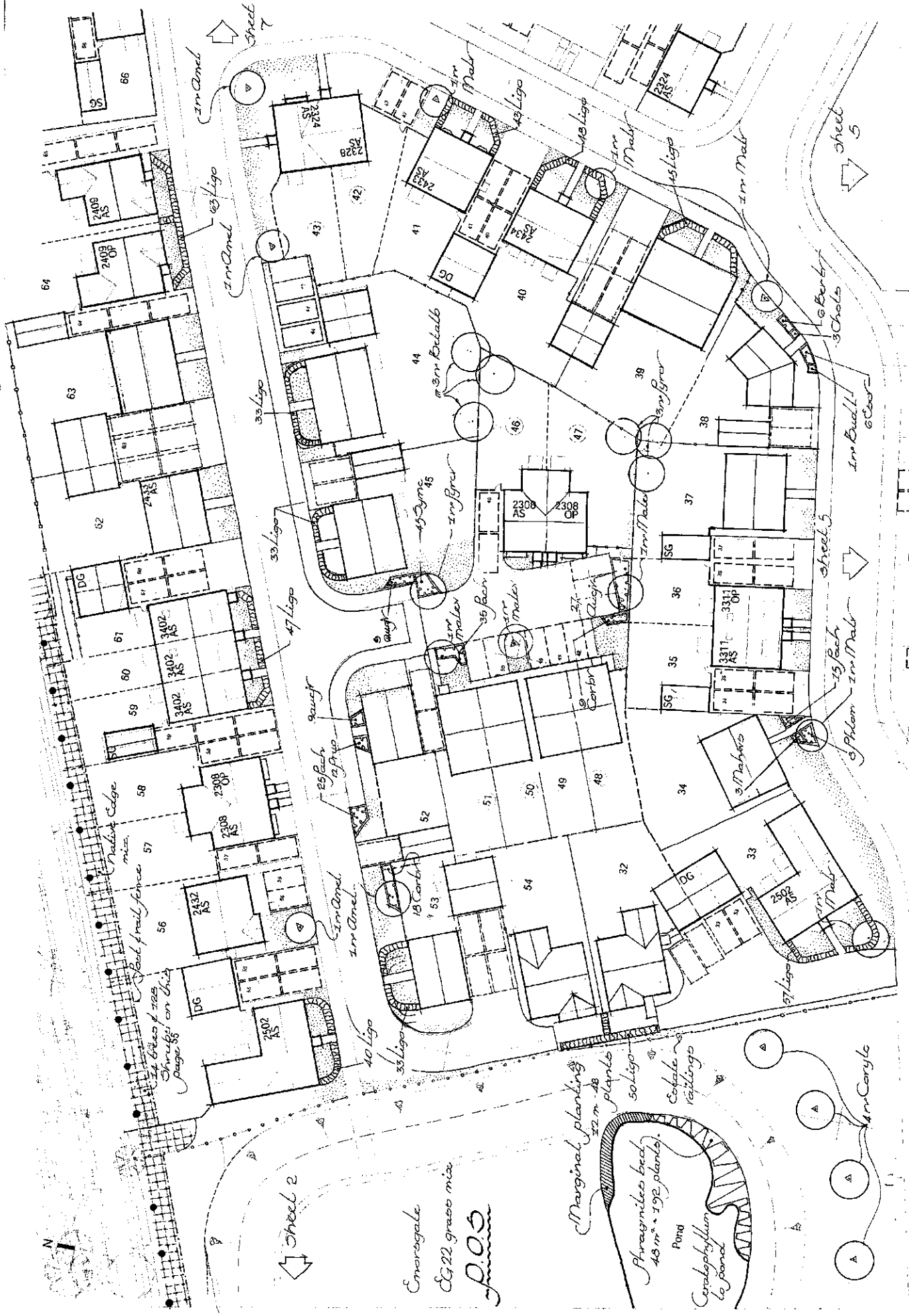

Emergale  
EG 22 grass mix  
P.O.S

Marginal planting  
32m x 18  
50 Ligo  
Ceratophyllum  
to pond  
Pond  
Phragmites bed  
48m x 192 plants.

1m Coryle

Larkfleet Homes  
 Fernwood, Newark  
 Landscape Proposals

Aug 19 (July 20)  
 sheet 3 of 14 rev. a  
 LH/FM/LAZ

Sheet 1

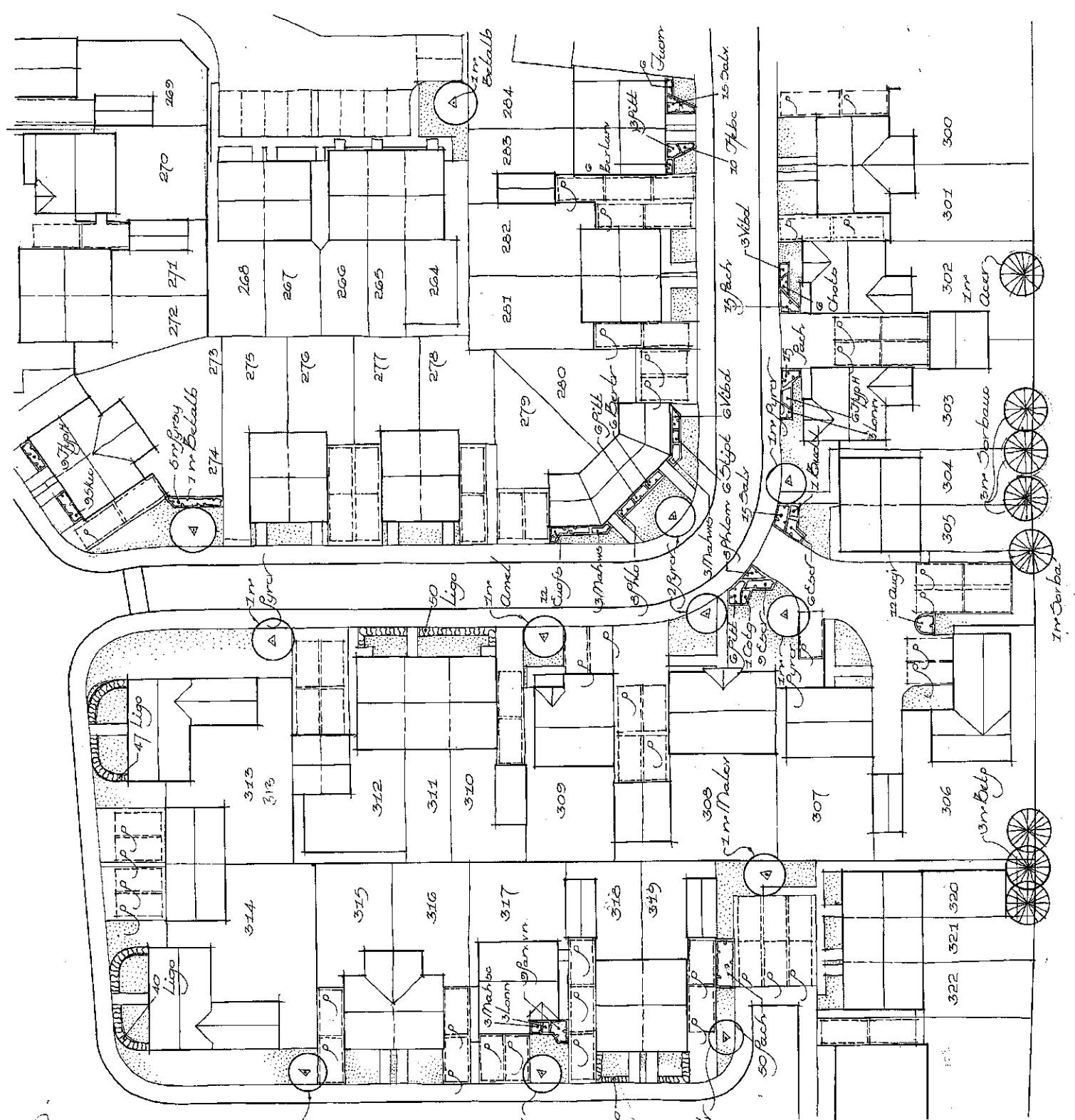

Larkfleet Homes - Fernwood, Newark

Landscape Proposals ~ August 2019 ~ 1:200 at A1 Sheet 2 of 24 LH-FK-LA1

330 Shrubs of 36 Trees on this page.

see p. 114 for planning changes etc.

